

72 W PORTSMOUTH ST

Location 72 W PORTSMOUTH ST

Mblu 49/Z 7 / / /

Owner NAGEL MAXWELL

Assessment \$319,200

Appraisal \$319,200

PID 5695

Building Count 1

Tract # 8292

Tract #

Tract #

Tract #

Tract #

Tract #

Current Value

Appraisal					
Valuation Year	Building	Extra Features	Outbuildings	Land	Total
2024	\$147,500	\$1,000	\$6,900	\$163,800	\$319,200
Assessment					
Valuation Year	Building	Extra Features	Outbuildings	Land	Total
2024	\$147,500	\$1,000	\$6,900	\$163,800	\$319,200

Owner of Record

Owner NAGEL MAXWELL

Sale Price \$375,000

Co-Owner

Certificate

Address 72 W PORTSMOUTH ST

Book & Page 3776/0179

CONCORD, NH 03301-5490

Sale Date 01/03/2022

Instrument 00

Ownership History

Ownership History					
Owner	Sale Price	Certificate	Book & Page	Instrument	Sale Date
NAGEL MAXWELL	\$375,000		3776/0179	00	01/03/2022
MARTINEAU CHRISTOPHER J &	\$240,000		3560/0646	00	06/22/2017
ROCKWELL MICHAEL D & JESSAMYN L	\$195,000		3264/0155	02	07/19/2011
LAMONTAGNE RONALD A & DEBRA A	\$170,000		2428/1240	02	11/22/2002
MINER BARBARA D	\$0		0/0	38	10/31/1997

Building Information

Building 1 : Section 1

Year Built: 1929
Living Area: 1,494
Replacement Cost: \$187,398
Replacement Cost Less Depreciation: \$147,500

Building Attributes

Field	Description
Style:	Conventional
Model	Residential
Grade:	Average +10
Stories:	2 Stories
Occupancy	1
Exterior Wall 1	Vinyl Siding
Exterior Wall 2	
Roof Structure:	Gable/Hip
Roof Cover	Asph/F GlS/Cmp
Interior Wall 1	Drywall/Sheet
Interior Wall 2	
Interior Flr 1	Hardwood
Interior Flr 2	Pine/Soft Wood
Heat Fuel	Oil
Heat Type:	Forced Air-Duc
AC Type:	None
Total Bedrooms:	3 Bedrooms
Total Bthrms:	2
Total Half Baths:	0
Total Xtra Fixtrs:	
Total Rooms:	7
Bath Style:	Average
Kitchen Style:	Modern
Num Kitchens	01
Cndtn	
Num Park	
Fireplaces	
Fndtn Cndtn	
Basement	
Usrflid 706	

Building Layout

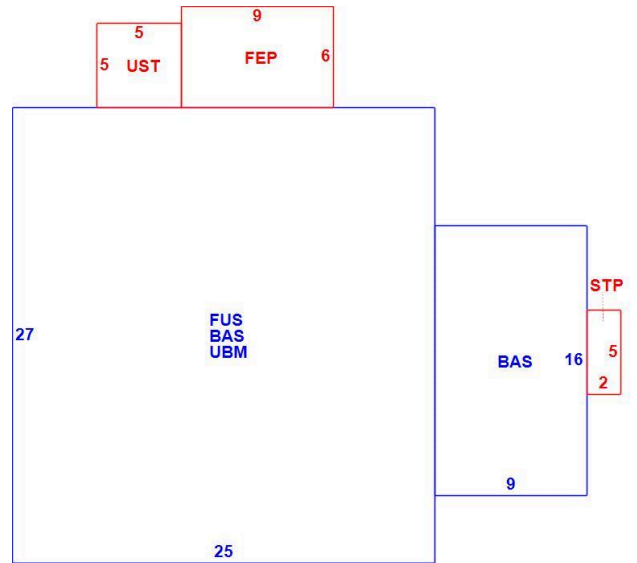

(ParcelSketch.ashx?pid=5695&bid=5933)

Building Sub-Areas (sq ft)

Legend

Code	Description	Gross Area	Living Area
BAS	First Floor	819	819
FUS	Upper Story, Finished	675	675
FEP	Porch, Enclosed, Finished	54	0
STP	Stoop	10	0
UBM	Basement, Unfinished	675	0
UST	Utility, Storage, Unfinished	25	0
		2,258	1,494

Extra Features

Extra Features							<u>Legend</u>
Code	Description	Size	Value	Assessed Value	Bldg #	Comment	
HRTH	HEARTH	1.00 UNITS	\$1,000	\$1,000	1	METAL FLU FOR WOODSTOVE IN 9X16 BAS	

Land

Land Use

Use Code 1010
Description SINGLE FAM MDL-01
Zone RO
Neighborhood 0112
Category

Land Line Valuation

Size (Acres) 2.2
Assessed Value \$163,800
Appraised Value \$163,800

Outbuildings

Outbuildings								<u>Legend</u>
Code	Description	Sub Code	Sub Description	Size	Value	Assessed Value	Bldg #	Comment
SHD1	SHED FRAME			144.00 S.F.	\$1,200	\$1,200	1	
FGR5	GARAGE W/LFT G			192.00 S.F.	\$5,700	\$5,700	1	